

NOTES:

1. Aggressive M6 hobbing
 2. Aggressive 216 straight form roll
- Parts must be clean, free of oil and debris
Must be ROHS compliant

Revision History

Rev	Date	Init	Notes:
IR	2/17/2017	BJB	
Rev A	5/17/2017	BJB	Redrawn for somestruder variant
Rev B	6/2/2017	BJB	Add center bore
Rev C	11/20/17	SAW	Add allowable radii/chamfer, Ø8.5mm, page 2
Rev D	2/2/18	SAW	Tightened tolerance and adjusted Ø4.965 to 4.96
Rev E	2/5/18	SAW	Restored tolerance and adjusted Ø4.96 to 4.94
Rev F	9/11/18	Kent	Tightened tolerance on OD of knurl 8.5 to 8.50

DRAWN BY: Baldwin	DATE: 5/17/17
MATERIAL: 303 Stainless	
UNLESS OTHERWISE SPECIFIED DIMENSIONS ARE IN MILLIMETERS. TOLERANCES ARE:	
DECIMALS .X±.75 .XX±.25 .XXX±.125 .XXXX±.050	ANGLES X°±1° 63
BREAK EDGES 0.1/0.5 FILLET RADIUS 0.1/0.5	



**ALEPH
OBJECTS
INCORPORATED**

626 West 66th Street
Loveland, Colorado 80538, USA
Phone +1-970-377-1111
www.alephobjects.com

TITLE Knurled gear shaft			
SIZE A	DWG NO. PP-MP0173	REV. F	
SCALE N/A	DO NOT SCALE DRAWING	SHEET 1 of 2	

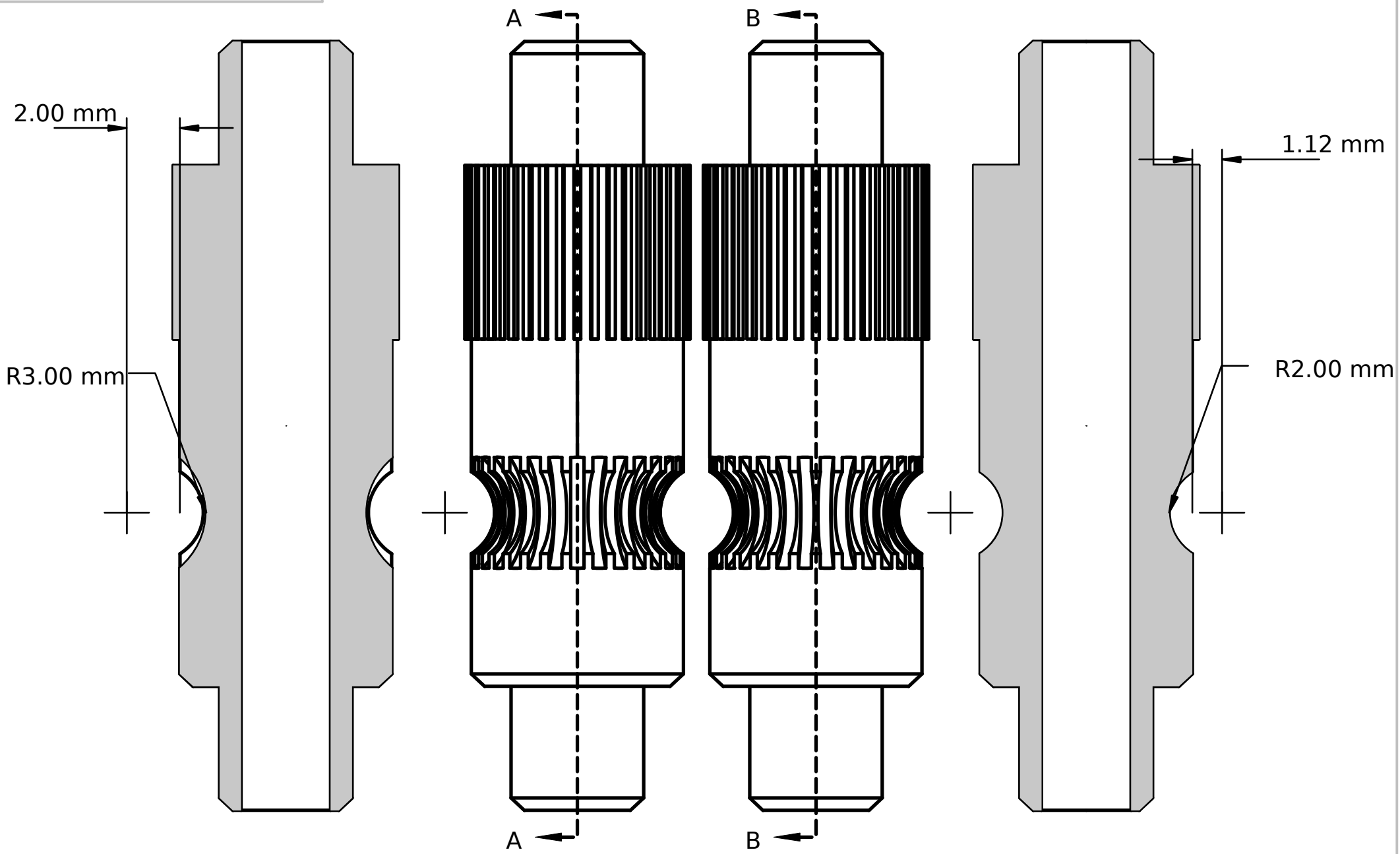

TITLE			
Knurled gear shaft			
SIZE	DWG NO.	REV.	
A	PP-MP0173	D	
SCALE	N/A	DO NOT SCALE DRAWING	SHEET 2 of 2