

NOTES:

1. Parts must be RoHS compliant.
2. Material: 5052 H-32 Aluminum
3. Break all sharp edges prior to powder coat.
4. Mask all threads and selected areas prior to coating.
5. Part is to be powder coated with Cardinal color C241-BK109.

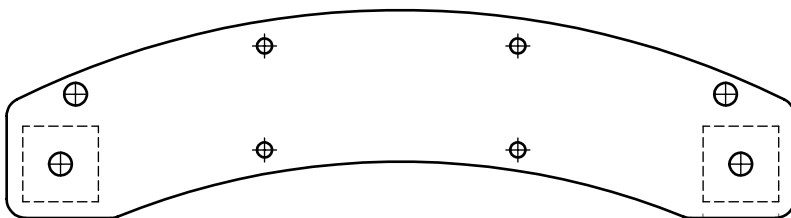

4. 2X 20.0 SQUARE CENTERED ON HOLE

SECTION A-A

DRAWN BY SINNEMA 8/1/13

MATERIAL SEE NOTES

UNLESS OTHERWISE SPECIFIED DIMENSIONS ARE IN MILLIMETERS. TOLERANCES ARE:

DECIMALS	ANGLES
.X ± .75	X° ± 1°
.XX ± .25	
.XXX ± .125	63
.XXXX ± .050	

BREAK EDGES .005/.020
FILLET RADIUS .005/.020



Sinnema Design Services

seth.sinnema@gmail.com
Phone: (303) 250-8218
Fax: 1-267-393-7872

TITLE

Y axis end motor

SIZE DWG NO.
A PP-FP0016

REV.
D

SCALE 1:2 DO NOT SCALE DRAWING SHEET 1 OF 1