

- Notes:
1. Material: RoHS compliant 12AWG (.08") Aluminum
  2. Part is to be Black Anodized. Mask all threads prior to coating.

DRAWN BY SINNEMA	1/9/14
MATERIAL See Notes	
UNLESS OTHERWISE SPECIFIED DIMENSIONS ARE IN MILLIMETERS. TOLERANCES ARE:	
DECIMALS .X $\pm .75$ .XX $\pm .25$ .XXX $\pm .125$ .XXXX $\pm .050$	ANGLES X° $\pm 1^\circ$ 63
BREAK EDGES .005/.020 FILLET RADIUS .005/.020	



**Sinnema Design Services**  
 seth.sinnema@gmail.com  
 Phone: (303) 250-8218  
 Fax: 1-267-393-7872

TITLE <b>Guava Sheet Metal Enclosure</b>		REV. A
SIZE A	DWG NO. PP-FP0030	
SCALE 1:3	DO NOT SCALE DRAWING	SHEET 1 OF 2

4X FEX-M5 Inserts  
Install from other side

4X SO-M3-6ZI Inserts  
Install from this side

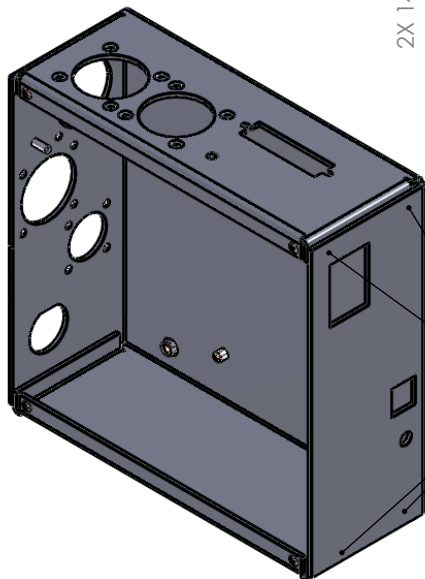
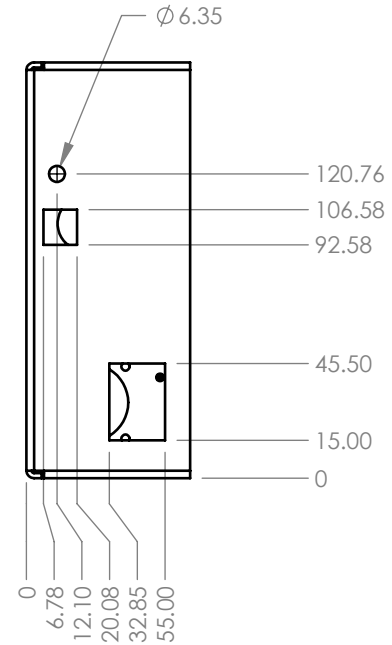
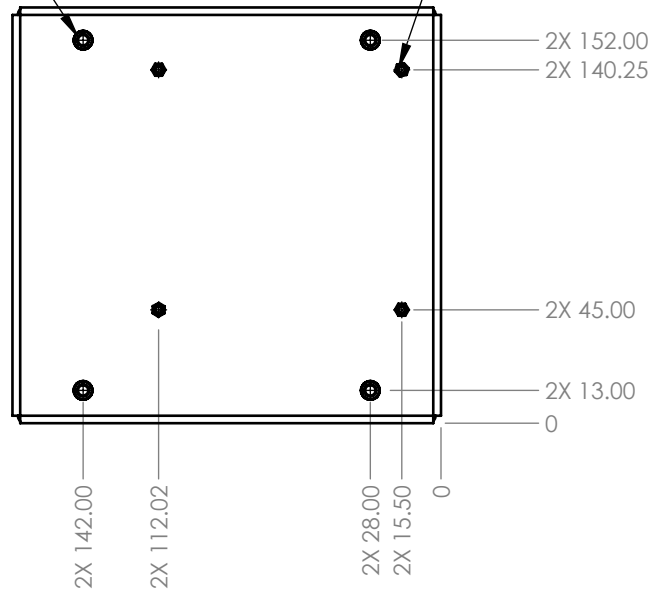

Spot weld 2x  
on each tab



Sinnema Design Services

seth.sinnema@gmail.com  
Phone: (303) 250-8218  
Fax: 1-267-393-7872

TITLE

Guava Sheet Metal Enclosure

SIZE  
A

DWG NO.

PP-FP0030

REV.  
A

SCALE

1:2

DO NOT SCALE DRAWING

SHEET

2 OF 2