

D-SUB SPECIFICATIONS

MATERIALS

Shell: Tin or zinc over copper plated steel
 Contacts: Male - Brass (gold plated over nickel)
 Female - Gold plated phosphor bronze
 Insulator: PBT & glass-fibre reinforced UL94V-0

ELECTRICAL

Current rating: 3 amps
 Working voltage: 125V RMS
 Dielectric strength: 1000 volts for 1 minute
 Insulation resistance: 1000MΩ @ 500VDC
 Temperature range: -55 to +105 degrees C

SOLDER D-SUB CONNECTORS

MALE



- 30-110-0** 9-position
 - 30-111-0** 15-position
 - 30-112-0** 25-position
 - 30-113-0** 37-position
 - 30-114-0** 50-position
- Use -1 for Display Package*

FEMALE



- 30-120-0** 9-position
 - 30-121-0** 15-position
 - 30-122-0** 25-position
 - 30-123-0** 37-position
 - 30-124-0** 50-position
- Use -1 for Display Package*

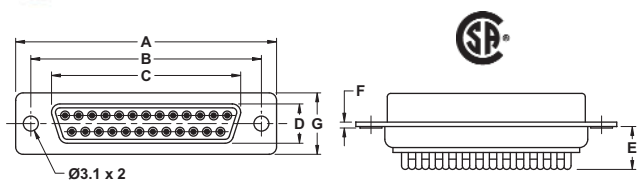
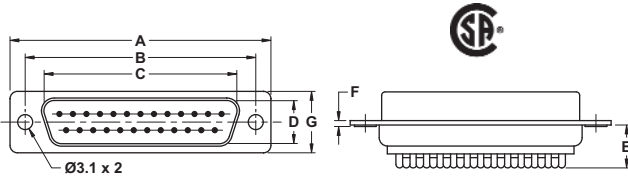

| Size | A | B | C | D | E | F | G |
|--------|-------|-------|-------|-------|-----|-----|------|
| 9-pin | 30.80 | 25.00 | 16.92 | 8.30 | 8.0 | 1.2 | 12.5 |
| 15-pin | 39.20 | 33.30 | 25.25 | 8.30 | 8.0 | 1.2 | 12.5 |
| 25-pin | 53.10 | 47.10 | 38.96 | 8.30 | 8.0 | 1.2 | 12.5 |
| 37-pin | 69.40 | 63.50 | 55.42 | 8.30 | 8.0 | 1.2 | 12.5 |
| 50-pin | 67.00 | 61.00 | 52.81 | 11.30 | 8.0 | 1.2 | 15.3 |

| Size | A | B | C | D | E | F | G |
|--------|-------|-------|-------|-------|-----|-----|------|
| 9-pin | 30.80 | 25.00 | 16.30 | 7.90 | 8.0 | 1.2 | 12.5 |
| 15-pin | 39.20 | 33.30 | 24.60 | 7.90 | 8.0 | 1.2 | 12.5 |
| 25-pin | 53.10 | 47.10 | 38.30 | 7.90 | 8.0 | 1.2 | 12.5 |
| 37-pin | 69.40 | 63.50 | 54.80 | 7.90 | 8.0 | 1.2 | 12.5 |
| 50-pin | 67.00 | 61.00 | 52.20 | 10.90 | 8.0 | 1.2 | 15.3 |

CRIMP D-SUB CONNECTORS

MALE



- 30-210-0** 9-position
 - 30-211-0** 15-position
 - 30-212-0** 25-position
 - 30-213-0** 37-position
- Display package (-1) contains connector body plus contacts*

FEMALE



- 30-220-0** 9-position
 - 30-221-0** 15-position
 - 30-222-0** 25-position
 - 30-223-0** 37-position
- Display package (-1) contains connector body plus contacts*

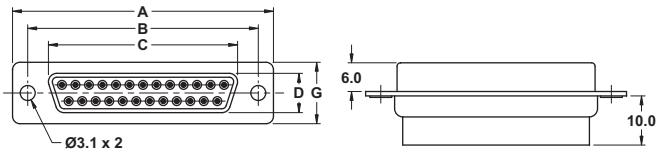
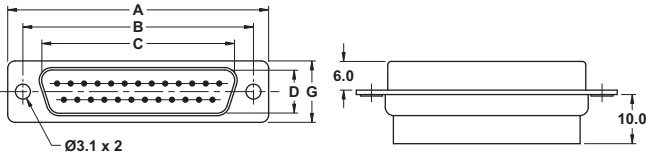

| Size | A | B | C | D | G |
|--------|-------|-------|-------|-------|------|
| 9-pin | 30.80 | 25.00 | 16.92 | 8.30 | 12.5 |
| 15-pin | 39.20 | 33.30 | 25.25 | 8.30 | 12.5 |
| 25-pin | 53.10 | 47.10 | 38.96 | 8.30 | 12.5 |
| 37-pin | 69.40 | 63.50 | 55.42 | 8.30 | 12.5 |
| 50-pin | 67.00 | 61.00 | 52.81 | 11.30 | 15.3 |

| Size | A | B | C | D | G |
|--------|-------|-------|-------|------|------|
| 9-pin | 30.80 | 25.00 | 16.30 | 7.90 | 12.5 |
| 15-pin | 39.20 | 33.30 | 24.60 | 7.90 | 12.5 |
| 25-pin | 53.10 | 47.10 | 38.30 | 7.90 | 12.5 |
| 37-pin | 69.40 | 63.50 | 54.80 | 7.90 | 12.5 |

D-SUB CRIMP CONTACTS

Contacts for 30-21X and 30-22X series D-sub connectors.

Gold plated D-sub contacts. Available loose or on 5,000 pce. reels for machine application. Suitable for 26-28 AWG wire size.



- 30-226-0** Male contacts (loose)
- 30-226-100** Display Package (100)
- 30-227-0** Male contacts (5,000 reel)

- 30-228-0** Female contacts (loose)
- 30-228-100** Display Package (100)
- 30-229-0** Female contacts (5,000 reel)

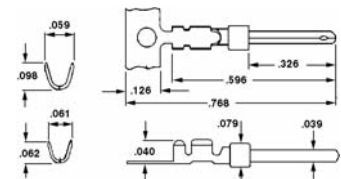

D-SUB ACCESSORIES

FEMALE LOCK POSTS



Locking hardware c/w nuts & washers (set of two)

30-023-0 Bulk only

MALE LOCK SCREWS



Locking screws c/w clip-on captivators (set of two)

30-028-0 Bulk only

MALE LOCK POSTS



Knurled lock posts - use with hoods (set 2)

30-030-0 Bulk only

D-SUB HOODS

Grey plastic D-sub hoods complete with all hardware

- 30-130-0** 9-position
 - 30-131-0** 15-position
 - 30-132-0** 25-position
 - 30-133-0** 37-position
 - 30-134-0** 50-position
- Use -1 for Display Package



Chrome plated plastic D-sub hoods for EMI/RFI shielding

- 30-230-0** 9-position
 - 30-231-0** 15-position
 - 30-232-0** 25-position
 - 30-233-0** 37-position
 - 30-234-0** 50-position
- Use -1 for Display Package

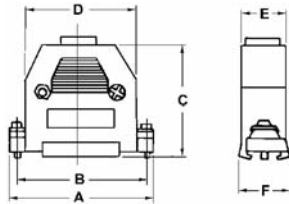

| Size | A | B | C | D | E | F |
|--------|-------|-------|-------|-------|------|------|
| 9-pin | 31.00 | 24.99 | 39.50 | 20.50 | 16.5 | 16.5 |
| 15-pin | 39.00 | 33.52 | 35.50 | 28.00 | 16.5 | 17.5 |
| 25-pin | 55.50 | 47.04 | 41.00 | 37.00 | 16.5 | 16.5 |
| 37-pin | 69.50 | 63.50 | 51.00 | 51.00 | 24.0 | 19.0 |
| 50-pin | 69.10 | 61.11 | 44.00 | 54.50 | 20.0 | 19.0 |



Die Cast Metal D-sub hoods complete with all hardware

- 30-230M-0** 9-position
 - 30-231M-0** 15-position
 - 30-232M-0** 25-position
- Use -1 for Display Package

| Size | A | B | C | D | E |
|--------|-------|-------|-------|-------|-------|
| 9-pin | 31.00 | 47.00 | 15.60 | 15.80 | 24.99 |
| 15-pin | 40.00 | 48.00 | 15.80 | 15.80 | 33.32 |
| 25-pin | 53.50 | 48.00 | 16.00 | 16.00 | 47.04 |

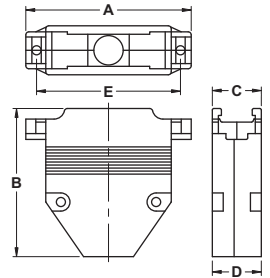

PRINTED CIRCUIT MOUNT D-SUBS

MALE

- 30-310-0** 9-position
 - 30-311-0** 15-position
 - 30-313-0** 37-position
 - 30-314-0** 50-position
- Use -1 for Display Package

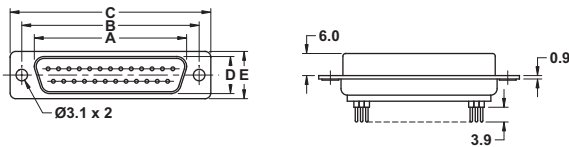

| Size | A | B | C | D | E |
|--------|-------|-------|-------|-------|------|
| 9-pin | 16.92 | 25.00 | 30.80 | 8.30 | 12.5 |
| 15-pin | 25.25 | 33.30 | 39.20 | 8.30 | 12.5 |
| 25-pin | 39.96 | 47.10 | 53.10 | 8.30 | 12.5 |
| 37-pin | 55.42 | 63.50 | 69.40 | 8.30 | 12.5 |
| 50-pin | 52.81 | 61.00 | 67.00 | 11.30 | 15.3 |

FEMALE

- 30-320-0** 9-position
 - 30-322-0** 25-position
 - 30-323-0** 37-position
 - 30-324-0** 50-position
- Use -1 for Display Package

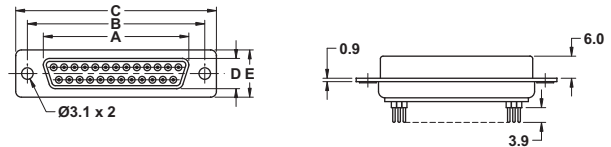

| Size | A | B | C | D | E |
|--------|-------|-------|-------|------|------|
| 9-pin | 16.30 | 25.00 | 30.80 | 7.90 | 12.5 |
| 25-pin | 38.30 | 47.10 | 53.10 | 7.90 | 12.5 |
| 37-pin | 54.80 | 63.50 | 69.40 | 7.90 | 12.5 |
| 50-pin | 52.20 | 61.00 | 67.00 | 10.9 | 15.3 |

MALE

HIGH DENSITY SOLDER D-SUBS

FEMALE



- 30-810-0** 15-position
 - 30-811-0** 26-position
 - 30-812-0** 44-position
- Use -1 for Display Package

- 30-820-0** 15-position
 - 30-821-0** 26-position
- Use -1 for Display Package



| Size | A | B | C |
|--------|-------|-------|-------|
| 15-pin | 16.92 | 25.00 | 30.80 |
| 26-pin | 25.25 | 33.30 | 39.20 |
| 44-pin | 38.96 | 47.10 | 53.10 |

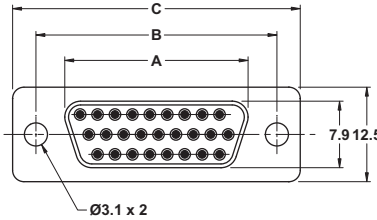
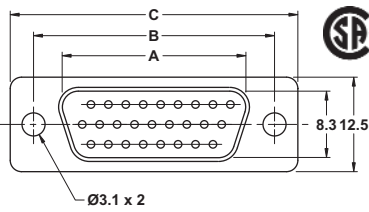

| Size | A | B | C |
|--------|-------|-------|-------|
| 15-pin | 16.30 | 25.00 | 30.80 |
| 26-pin | 24.60 | 33.30 | 39.20 |

RIGHT ANGLE P.C. MOUNT D-SUB

.318"/8.1mm footprint

MALE

FEMALE



- 30-410-0** 9-position
 - 30-411-0** 15-position
 - 30-412-0** 25-position
- Use -1 for Display Package

- 30-420-0** 9-position
 - 30-421-0** 15-position
 - 30-422-0** 25-position
 - 30-423-0** 37-position
- Use -1 for Display Package



| Size | A | B | C |
|--------|-------|-------|-------|
| 9-pin | 16.92 | 25.00 | 30.80 |
| 15-pin | 25.25 | 33.30 | 39.20 |
| 25-pin | 38.60 | 47.10 | 53.10 |

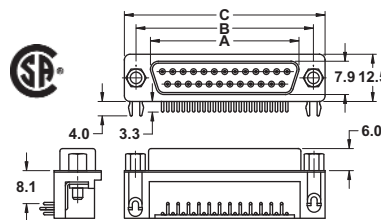
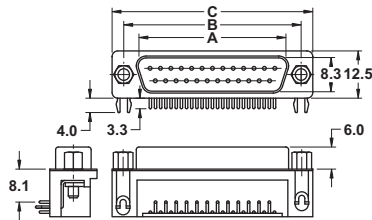

| Size | A | B | C |
|--------|-------|-------|-------|
| 9-pin | 16.30 | 25.00 | 30.80 |
| 15-pin | 24.60 | 33.30 | 39.20 |
| 25-pin | 38.30 | 47.10 | 53.10 |
| 37-pin | 54.80 | 63.50 | 69.4 |

MALE

RIBBON CABLE D-SUBS

FEMALE



- 30-710-0** 9-position
 - 30-711-0** 15-position
 - 30-712-0** 25-position
 - 30-713-0** 37-position
- Use -1 for Display Package

- 30-720-0** 9-position
 - 30-721-0** 15-position
 - 30-722-0** 25-position
- Use -1 for Display Package



| Size | A | B | C |
|--------|-------|-------|-------|
| 9-pin | 16.92 | 25.00 | 30.80 |
| 15-pin | 25.25 | 33.30 | 39.20 |
| 25-pin | 38.60 | 47.10 | 53.10 |
| 37-pin | 55.42 | 63.50 | 69.4 |

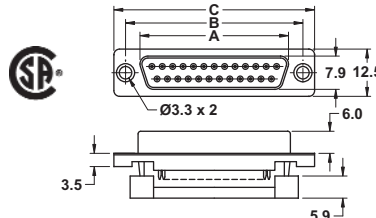
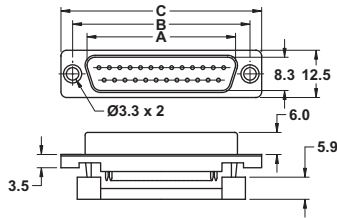

| Size | A | B | C |
|--------|-------|-------|-------|
| 9-pin | 16.30 | 25.00 | 30.80 |
| 15-pin | 24.60 | 33.30 | 39.20 |
| 25-pin | 38.30 | 47.10 | 53.10 |

HIGH DENSITY R/A P.C. MOUNT D-SUBS (FEMALE)



- 30-860-0** 15-position
 - 30-861-0** 26-position
- Use -1 for Display Package

| Size | A | B | C | D |
|--------|-------|------|-------|-------|
| 15-pin | 16.30 | 12.5 | 25.00 | 30.80 |
| 26-pin | 24.60 | 12.5 | 33.30 | 39.20 |

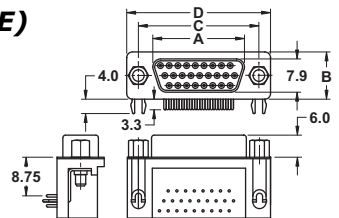

CENTRONICS CONNECTOR

RIBBON CABLE PLUG



30-942-0 36-position
Use -1 for Display Package